

USS (TYPE A WIDE) FLAT WASHERS

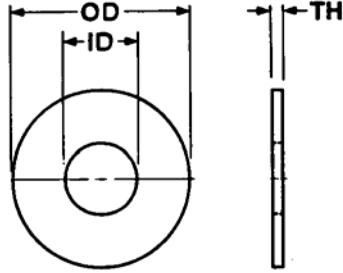

Bolt Size, In.	Outside Dia., In.	Inside Dia., In.	American Standard Gauge	Approx. Lbs. Per M Pcs.	Approx. No./Pcs. Per Lb.
3/16	9/16	1/4	18 (3/64)	2.8	361
1/4	3/4	5/16	16 (1/16)	6.7	149
5/16	7/8	3/8	14 (5/64)	11.5	87
3/8	1	7/16	14 (5/64)	14.9	67
7/16	1-1/4	1/2	14 (5/64)	24.4	41
1/2	1-3/8	9/16	12 (7/64)	38.5	26
9/16	1-1/2	5/8	12 (7/64)	45.5	22
5/8	1-3/4	11/16	10 (9/64)	77	13
3/4	2	13/16	9 (5/32)	110	9.1
7/8	2-1/4	15/16	8 (11/64)	153	6.5
1	2-1/2	1-1/16	8 (11/64)	188	5.3
1-1/8	2-3/4	1-1/4	8 (11/64)	220	4.5
1-1/4	3	1-3/8	8 (11/64)	260	3.8
1-3/8	3-1/4	1-1/2	7 (3/16)	333	3
1-1/2	3-1/2	1-5/8	7 (3/16)	385	2.6
1-5/8	3-3/4	1-3/4	7 (3/16)	448	2.3
1-3/4	4	1-7/8	7 (3/16)	500	2
1-7/8	4-1/4	2	7 (3/16)	569	1.8
2	4-1/2	2-1/8	7 (3/16)	630	1.6
2-1/4	4-3/4	2-3/8	5 (7/32)	826	1.2
2-1/2	5	2-5/8	4 (15/64)	961	1
2-3/4	5-1/4	2-7/8	3 (1/4)	1100	.9
3	5-1/2	3-1/8	2 (5/32)	1300	.8